

OPTICAL PROFILE PROJECTORS



HE400

HB400

HD400

VB400

VF600

HF600

HF750

HS600

HS750

HS1000

HF750 HORIZONTAL FLOOR STANDING OPTICAL PROJECTOR



Starrett®

METROLOGY **S**OLUTIONS

www.starrett-precision.co.uk



The same exemplary build standards as the HF600, the HF750 benefits from an even larger 762mm (30") screen.

This large fully usable screen sets a new benchmark for levels of clarity and brightness.

Ideal for use over a broad sweep of industries, the HF750 projector is designed and built to satisfy the requirements to measure large work pieces with total precision and efficiency.

This machine can now be supplied with a 2 lens turret capable of holding a 5x lens and one other lens or as a 5x fixed lens machine.

Features & Specifications

- Available with the full range of Metlogix or Quadra-Chek readout systems (as shown).
- Fully usable 762mm / 30" diameter screen with precision cross lines and overlay clips.
- 3-lens quick change turret, blanking caps supplied for unused apertures.
- 2-lens turret system also available, one aperture for a 5x lens and one for another magnification. Fixed 5x lens machine also available.
- Machine tool standard workstage, powered on both horizontal and vertical axis, with 630 x 230mm / 25 x 9" top plate. CNC options available.
- Workstage capacity between centres 440mm / 17.5"
- Standard measuring travel: 300mm / 12" X-axis, 200mm / 8" Y-Axis
- Extended measuring travel: 500mm / 20" X-axis, 200mm / 8" Y-Axis
- Fully retractable duplex fibre optic surface illumination.
- Exceptionally stable, all metal construction for optimum performance and accuracy.
- Supplied complete with full canopy and curtains.
- Stage weight capacity: 150kg / 330lbs (evenly distributed).
- 5x, 10x, 20x, 25x, 31.25x 50x and 100x lenses available.
- Screen driven rotary Q axis.
- 0.001mm resolution Heidenhain linear scales.
- Large range of accessories available, including alternative workstage, precision centres, vees, vices etc.
- Power supply 110 / 120 / 230 / 240 / 250V AC 50 / 60Hz.
- All Starrett Optical Profile Projectors have lens magnifications set and calibrated to the following accuracies:
Profile: $\pm 0.05\%$.
Surface Illumination: $\pm 0.10\%$.

M2 Touchscreen Readout

The Metlogix M2 readout has a broad range of powerful, user-friendly functions on a compact, icon based touchscreen interface in place of the traditional control.

The M2 software and the touchscreen interface are supplied separately, allowing users to purchase the interface in local markets if required.



Quadra-Chek Readouts

The Quadra-Chek readout range is considered as the industry standard for the precision measurement and inspection of geometric components.

Their design reflects a deep understanding of user needs, with an intuitive user interface and simple, meaningful visual displays; innovations that improve operator productivity, reduce errors and save time and money.



READOUT OPTIONS								
SPECIFICATION:	QUADRA-CHEK						METLOGIX	
	SR121	SR221	SR221e	QC321	QC321e	SR515	M2	M2e
Touchscreen operation				•	•		•	•
Angular digital measurement in readout	•	•	•	•	•	•	•	•
X-Y-Q axis digital readout	•	•	•	•	•	•	•	•
Geometric function digital readout		•	•	•	•	•	•	•
Computer with geometric software readout.						•		
On screen edge sensing			•		•	•		•
Functions •								

Field of View Terminology:

Working Distance: Is the distance between the objective lens and the component when the component is in focus.

Field of View (FOV): Is the viewing area of the component. A 30mm FOV using a 10x lens would produce a screen image of 300mm.

Half Field View: Is the maximum size a component can be projected to the centre of the screen before colliding with the lens.

Full Field View: Is the maximum size a component can be projected over the full screen before colliding with the lens.

Projected Image: Is how a component is projected onto the screen in relation to its placement on the workstage.

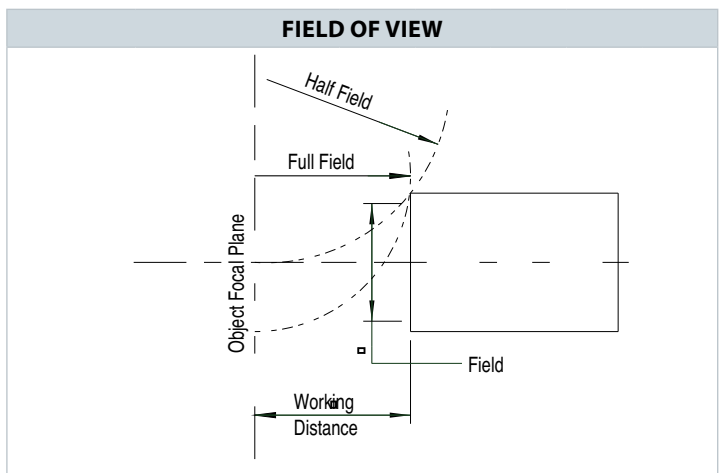

GUIDE TO MAXIMUM COMPONENT SIZE (MM)							
MAGNIFICATION		X5	X10	X20	X25	X50	X100
Field of View		150	75	37.5	30	15	7.5
Working Distance		230	151	101	92	60	48
Max Work Diameter	Half Field	400	400	340	280	145	160
	Full Field	400	340	240	220	125	130
Projected Image		Vertically Correct					

HF750 Dimensions

HF600 dimensions are as listed in the image, all measurements are in millimetres.

Gross Weight: 810kg.

Nett Weight: 660kg.

Shipping dimensions: 244 x 124 x 230cm.

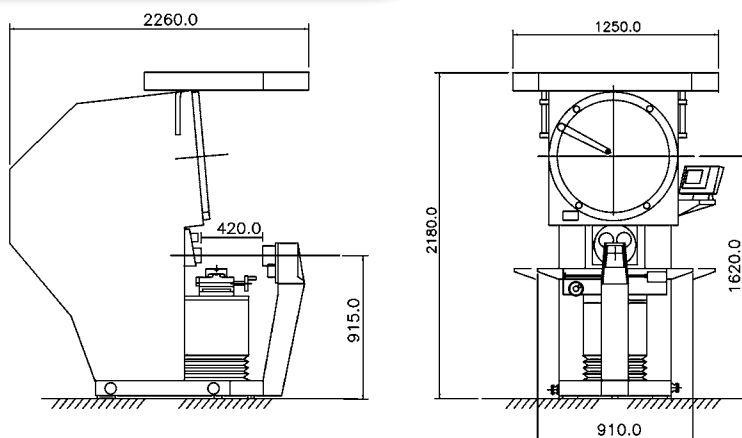

Accessories

Starrett manufacture a comprehensive range of fixtures and accessories to suit our full range of profile projectors.

Each accessory is made from the highest quality material and is machined, assembled and inspected to the same stringent quality standards as the projector itself.

ACCESSORIES

PART NO	DESCRIPTION	PART NO	DESCRIPTION	PART NO	DESCRIPTION
0CN3	Large Centres and Vees	0RV2	52mm Capacity Rotary Vice	0CN7	Small Centres and Vees
PART NO	DESCRIPTION	PART NO	DESCRIPTION	PART NO	DESCRIPTION
0VH1	Vertical Glass Plate Holder	0GH1	Magnification Check Graticule	4H003	32mm Capacity Rotary Vice
PART NO	DESCRIPTION	PART NO	DESCRIPTION		
4H002	32mm Capacity Fixed Vice	4H004	Universal Rotary Vee Block		

Starrett®

Starrett Precision Optical Ltd.
Oxnam Road
Jedburgh
Scotland
TD8 6LR

Tel: 00 44 (0) 1835 863501

Fax: 00 44 (0) 1835 866300

E mail: sales@starrett-precision.co.uk

Web: www.starrett-precision.co.uk

Issue: 10/12